

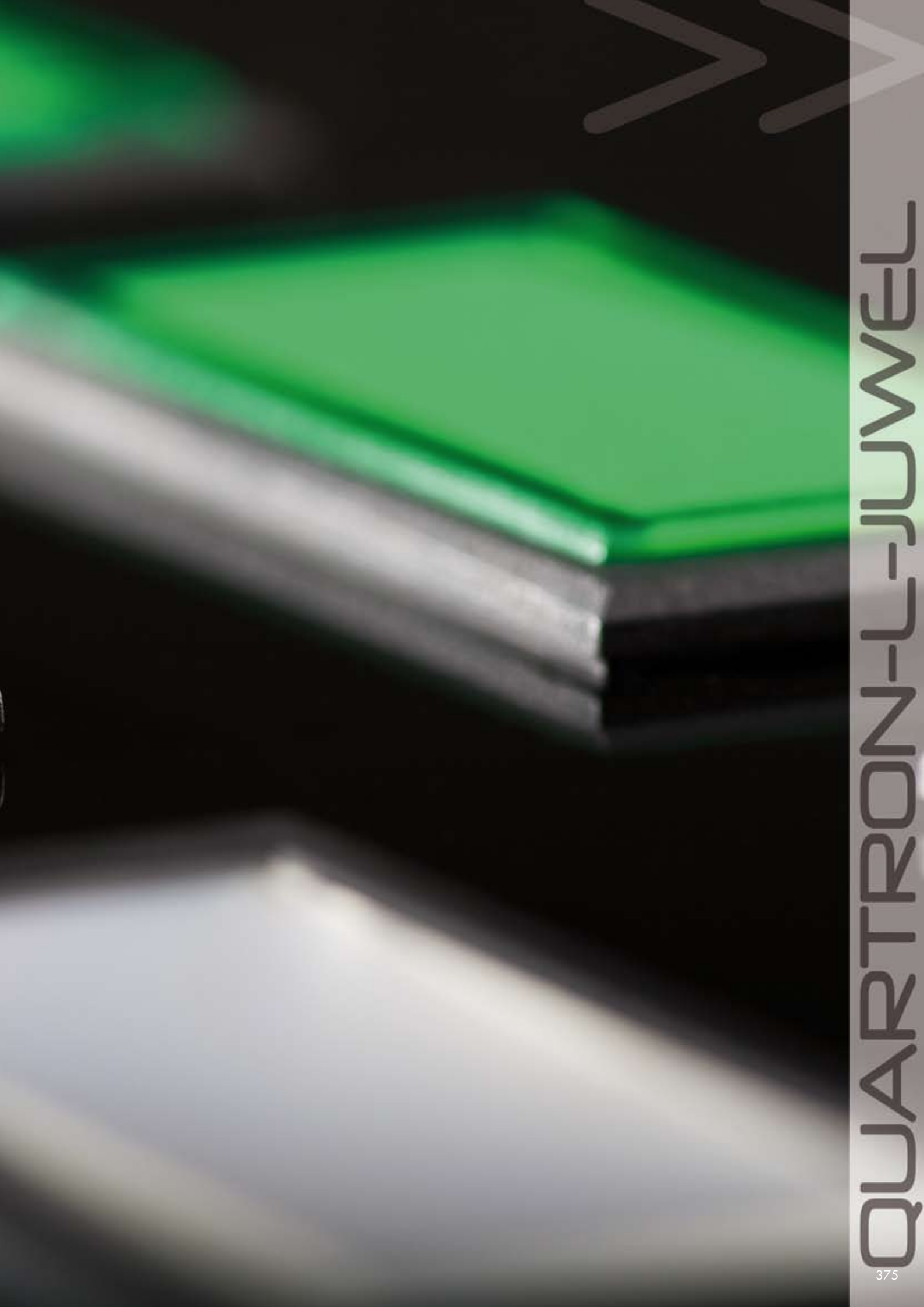

Front dimensions: 54 x 27 mm  
Panel cut-out: 48 x 24 mm  
Front bezel height: 2.5 mm  
Travel: 6 mm



# QUARTZTRON-L-JUWEL

## Mounting Depth Dimensions

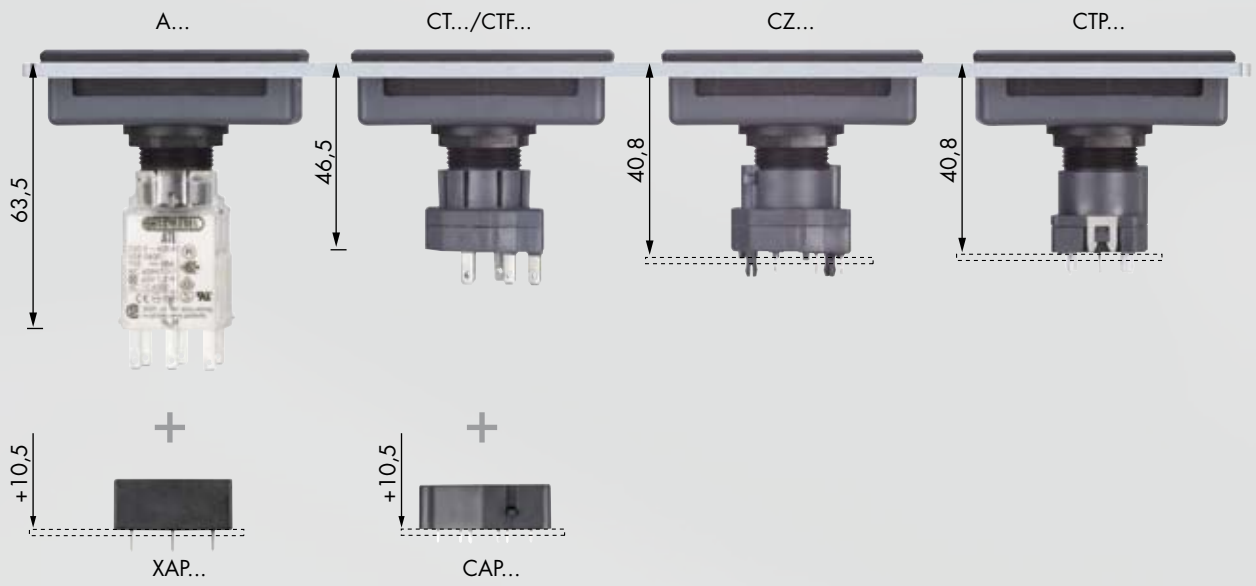

## Cutout Dimensions

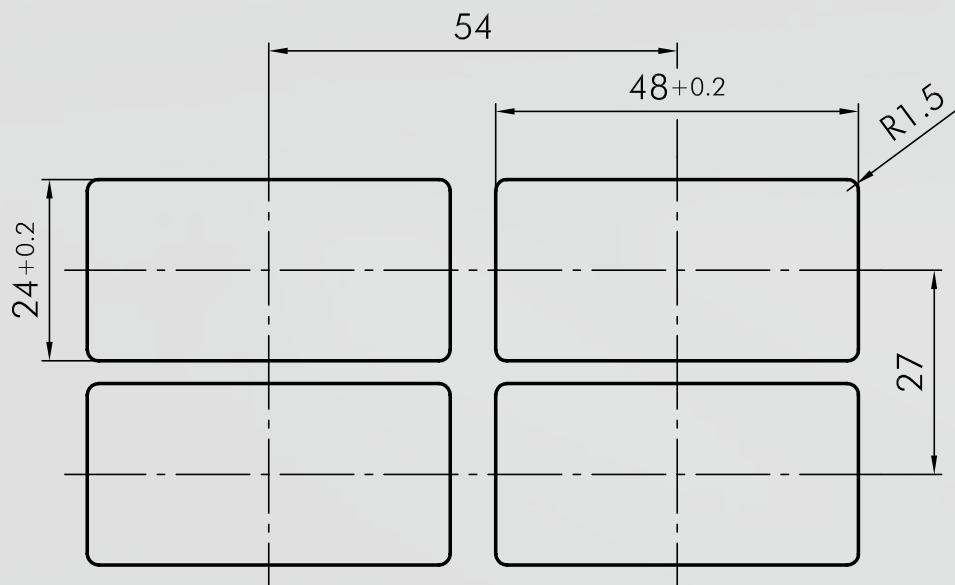

|          | LXJL5 | LXJN | LXJT | LXJTT |
|----------|-------|------|------|-------|
| AF       |       |      | ●    | ●     |
| AF2      |       |      | ●    | ●     |
| AFL      |       |      | ●    | ●     |
| AFL2     |       |      | ●    | ●     |
| AL5      |       | ●    |      |       |
| AL5-220  |       | ●    |      |       |
| AT       |       |      | ●    | ●     |
| AT2      |       |      | ●    | ●     |
| ATI      |       |      | ●    | ●     |
| ATL      |       |      | ●    | ●     |
| ATL2     |       |      | ●    | ●     |
| ATO      |       |      | ●    | ●     |
| AZ011_97 |       |      | ●    | ●     |
| AZ2      |       |      | ●    | ●     |
| AZOO     |       |      | ○    | ○     |
| AZOW1    |       |      | ○    | ○     |
| CL       |       | ●    |      |       |
| CLP_485  |       | ●    |      |       |
| CT       |       |      | ○    | ○     |
| CT2      |       |      | ○    | ○     |
| CTF      |       |      | ○    | ○     |
| CTL      |       |      | ○    | ○     |
| CTL2     |       |      | ○    | ○     |
| CTLF     |       |      | ○    | ○     |
| CTLP_485 |       |      | ○    | ○     |
| CTP_485  |       |      | ○    | ○     |
| CZLP     |       | ●    |      |       |
| CZTLP    |       |      | ○    | ○     |
| CZTLP2   |       |      | ○    | ○     |
| CZTP     |       |      | ○    | ○     |
| CZTP2    |       |      | ○    | ○     |
| L5       |       | ●    |      |       |
| PTFOI    |       |      | ○    | ○     |
| PTFOO    |       |      | ○    | ○     |
| PTPOI    |       |      | ○    | ○     |
| PTPOO    |       |      | ○    | ○     |

- possible combination  
● optimal combination

24 x 48 mm

## Pushbutton Heads (momentary/push-push)

Lenses and nameplates to be ordered separately

Illustration

Dimensions

Description

Type

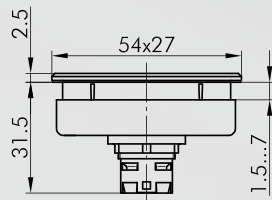

### Pushbutton Head 54 x 27 mm

front bezel      black  
                         charcoal

**LXJT**  
**LXJTDG**



### Concave Lens, transparent

available in blue-BL, yellow-GB, green-GN, clear-KL,  
red-RT, opalwhite-WS,  
add code letter to type number, e.g. T50DBL

**T50D...**



### Flat Lens, transparent

available in blue-BL, yellow-GB, green-GN, clear-KL,  
red-RT, opalwhite-WS,  
add code letter to type number, e.g. T50FBL

**T50F...**



### High Lens, transparent

available in blue-BL, yellow-GB, green-GN, clear-KL,  
red-RT, opalwhite-WS,  
add code letter to type number, e.g. T50HBL

**T50H...**



### Nameplate

with standard imprint, please specify index number  
(see nameplates)

**BSLX...**

### Nameplate

with special imprint according to customer's specifications

**BSLXB**

## Pushbutton Heads (momentary/push-push)

Lenses and nameplates to be ordered separately



| Illustration   | Dimensions | Description  | Type                           |
|--|------------|--|--------------------------------|
|   |            | <b>Blank Nameplate</b>   | <b>BSLXU</b>                   |
|   |            | <b>Double Pushbutton Head 54 x 27 mm</b><br>front bezel      black<br>charcoal   | <b>LXJTT</b><br><b>LXJTTDG</b> |
|   |            | <b>Concave Lens, transparent</b><br>available in blue-BL, yellow-GB, green-GN, clear-KL,<br>red-RT, opalwhite-WS,<br>add code letter to type number, e.g. T25DBL   | <b>T25D...</b>                 |
|   |            | <b>Flat Lens, transparent</b><br>available in blue-BL, yellow-GB, green-GN, clear-KL,<br>red-RT, opalwhite-WS,<br>add code letter to type number, e.g. T25FBL  | <b>T25F...</b>                 |
|   |            | <b>Flat Lens, non-transparent</b><br>used in pushbuttons without inscription and<br>illumination,<br>available in blue-BL, yellow-GB, green-GN, black-SW,<br>red-RT, white-WS,<br>add code letter to type number, e.g. T25FGWS | <b>T25FG...</b>                |
|   |            | <b>High Lens, transparent</b><br>available in blue-BL, yellow-GB, green-GN, clear-KL,<br>red-RT, opalwhite-WS,<br>add code letter to type number, e.g. T25HBL  | <b>T25H...</b>                 |

# QUARTRON-LJUWEL

24 x 48 mm



## Accessories for Actuators

| Illustration  | Dimensions | Description  | Type           |
|---|------------|--|----------------|
|    |            | <b>Nameplate</b><br>with standard imprint, please specify index number<br>(see nameplates) | <b>BSQX...</b> |
|   |            | <b>Nameplate</b><br>with special imprint according to customer's specifications            | <b>BSQXB</b>   |
|    |            | <b>Blank Nameplate</b>   | <b>BSQXU</b>   |
|  | IP67       | <b>Sealing Cap</b><br>made of silicone rubber, down to -50°C                               | <b>TK55S</b>   |

## Pilot Light Heads/Pilot Lights

Lenses and nameplates to be ordered separately

Illustration

Dimensions

Description

Type

IP65



### Pilot Light 54 x 27 with Faston terminals 2.8x0.8 mm

T5.5K socket

front bezel

black

charcoal

**LXJL5**

**LXJL5DG**

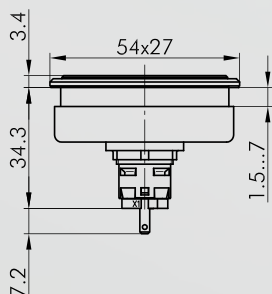

IP65



### Pilot Light Head 54 x 27 mm

front bezel

black

charcoal

**LXJN**

**LXJNDG**

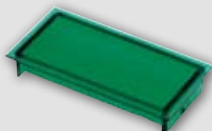
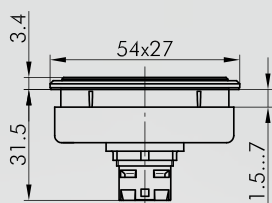

### Flat Lens, depolished

available in blue-BL, yellow-GB, green-GN, clear-KL,  
red-RT, opalwhite-WS,  
add code letter to type number, e.g. KF50BL

**KF50...**



### Flat Lens, transparent

available in blue-BL, yellow-GB, green-GN, clear-KL,  
red-RT, opalwhite-WS,  
add code letter to type number, e.g. KF50KSBL

**KF50KS...**



## Accessories for Actuators

| Illustration | Dimensions | Description | Type |
|--------------|------------|-------------|------|
|--------------|------------|-------------|------|







|  |  |  |                |
|--|--|--|----------------|
|  |  | <b>Nameplate</b><br>with standard imprint, please specify index number<br>(see nameplates) | <b>BSLX...</b> |
|--|--|--|----------------|

|  |  |   |              |
|--|--|---|--------------|
|  |  | <b>Nameplate</b><br>with special imprint according to customer's specifications | <b>BSLXB</b> |
|--|--|---|--------------|



|  |  |                        |              |
|--|--|------------------------|--------------|
|  |  | <b>Blank Nameplate</b> | <b>BSLXU</b> |
|--|--|------------------------|--------------|

## Accessories for Actuators

| Illustration  | Dimensions | Description  | Type         |
|---|------------|--|--------------|
|    |            | <b>Hexagonal Mounting Tool</b><br>with torque limitation,<br>for the series OKTRON, OKTRON-JUWEL,<br>OKTRON-R, RONTRON-R-JUWEL, RONTRON-R-<br>Exclusive, RONTRON-Q-JUWEL, RONTRON-Q-<br>Exclusive, QUARTRON(-L), QUARTRON-JUWEL(-L),<br>RX, RX-JUWEL | <b>S16</b>   |
|    |            | <b>Mounting Tool Adapter with 1/4" connections</b><br>for mounting tools S16 and S22   | <b>SRA</b>   |
|  |            | <b>Lamp Remover</b>  | <b>LZ-MG</b> |
|  |            | <b>Universal Lens Remover</b>  | <b>USK</b>   |

- Order
- About Us
- Control Units
- Actuators
- Bus Technology
- Follow-ups
- Limit Switches
- Mobile Switches
- Terminal Blocks