



Front dimensions: \varnothing 28 mm
Panel cut-out: \varnothing 22.3 mm
Front bezel height: 2.6 mm
Travel: 3 mm



REX-JUWEL





- 01 Pushbutton Heads page 184
- 02 Emergency Stop Buttons page 185
- 03 Knob Set for Potentiometers page 186
- 04 Selector Heads page 186
- 05 Key Actuators page 187
- 06 Acoustic Buzzers page 188

- 07 Pilot Lights page 191

Contact Blocks / Lampholders page 414



 degree of protection

 illuminating option

 operating travel

 labelling option

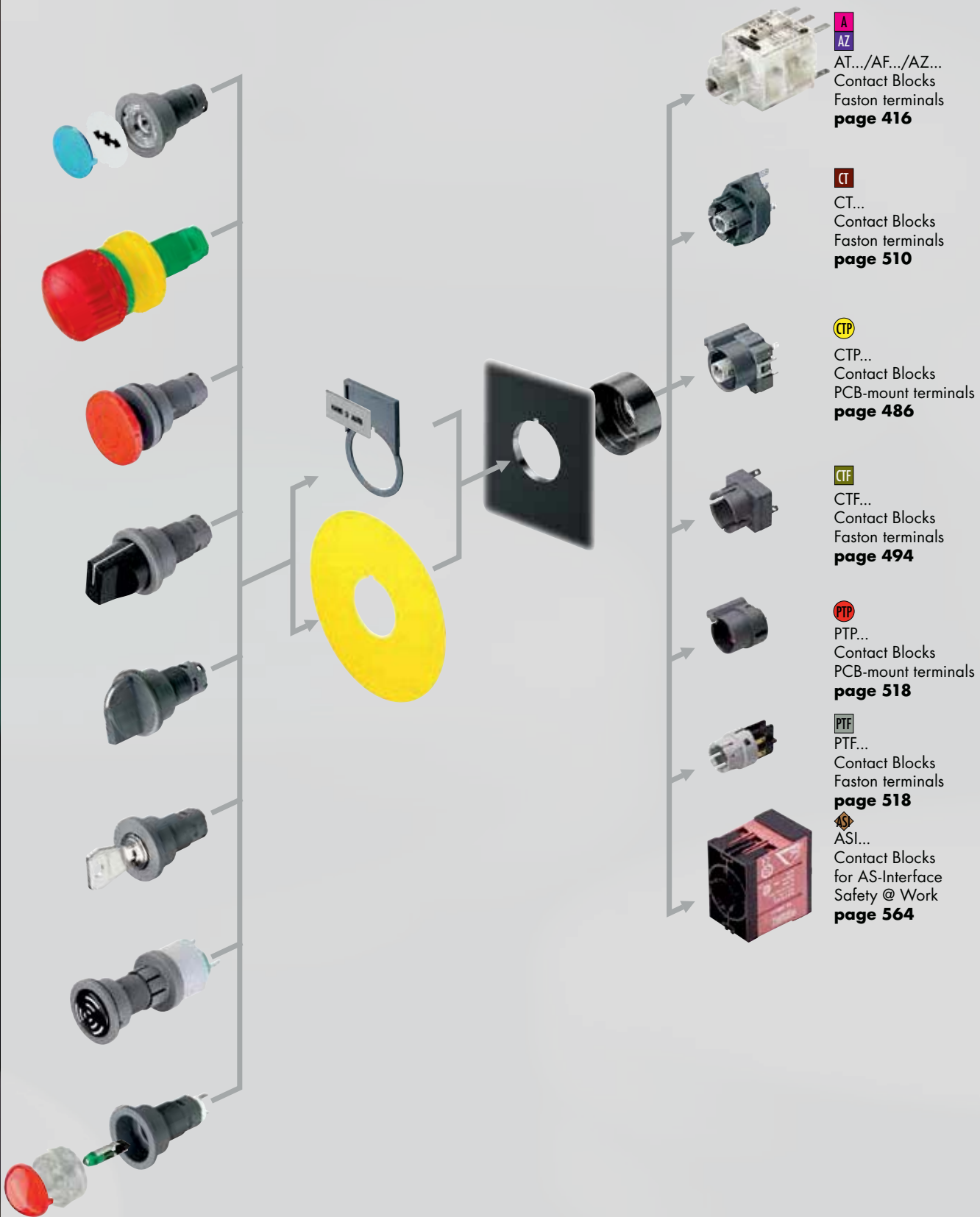

A
AZ

AT.../AF.../AZ...
Contact Blocks
Faston terminals
page 416

CT

CT...
Contact Blocks
Faston terminals
page 510

CTP

CTP...
Contact Blocks
PCB-mount terminals
page 486

CTF

CTF...
Contact Blocks
Faston terminals
page 494

PTP

PTP...
Contact Blocks
PCB-mount terminals
page 518

PTF

PTF...
Contact Blocks
Faston terminals
page 518

ASI

ASI...
Contact Blocks
for AS-Interface
Safety @ Work
page 564

Mounting Depth Dimensions

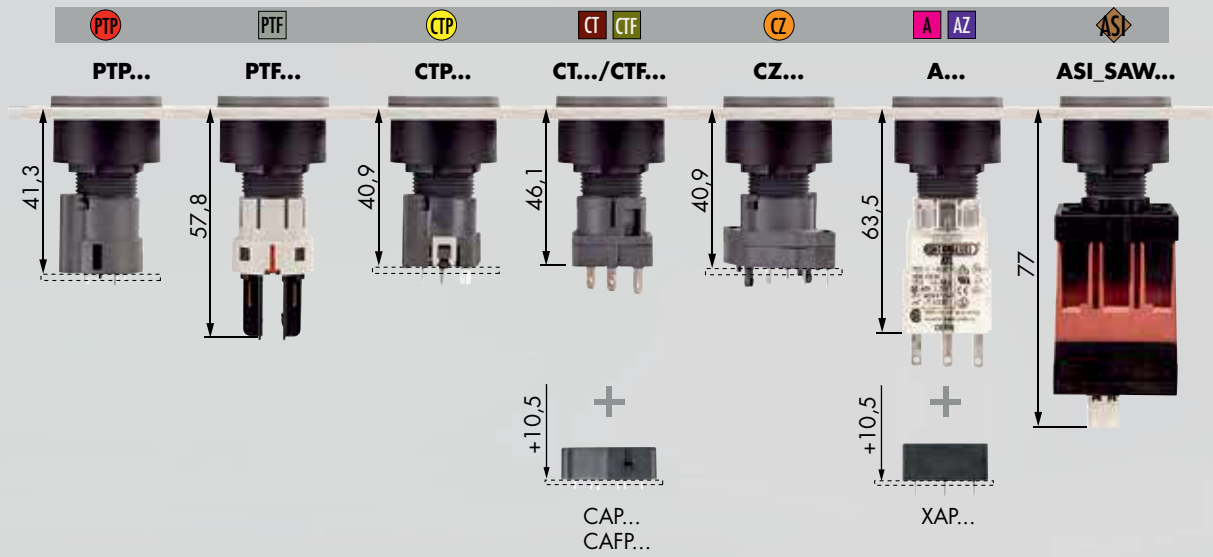

Cutout Dimensions

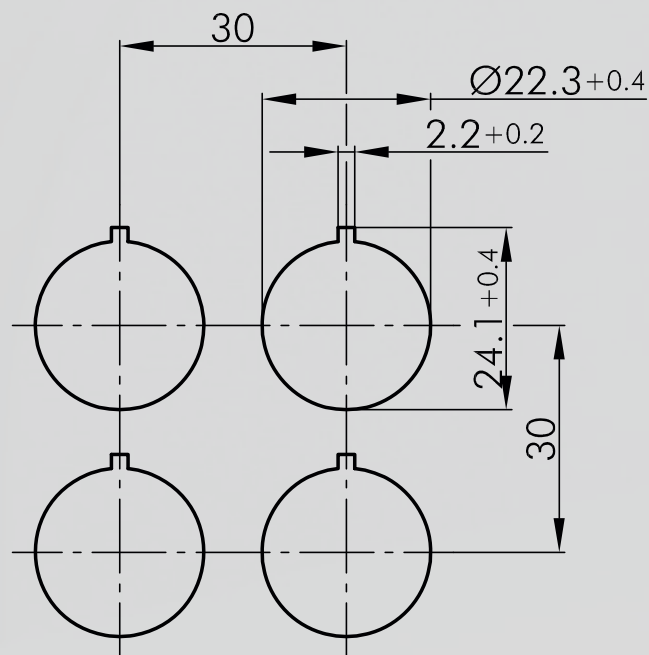

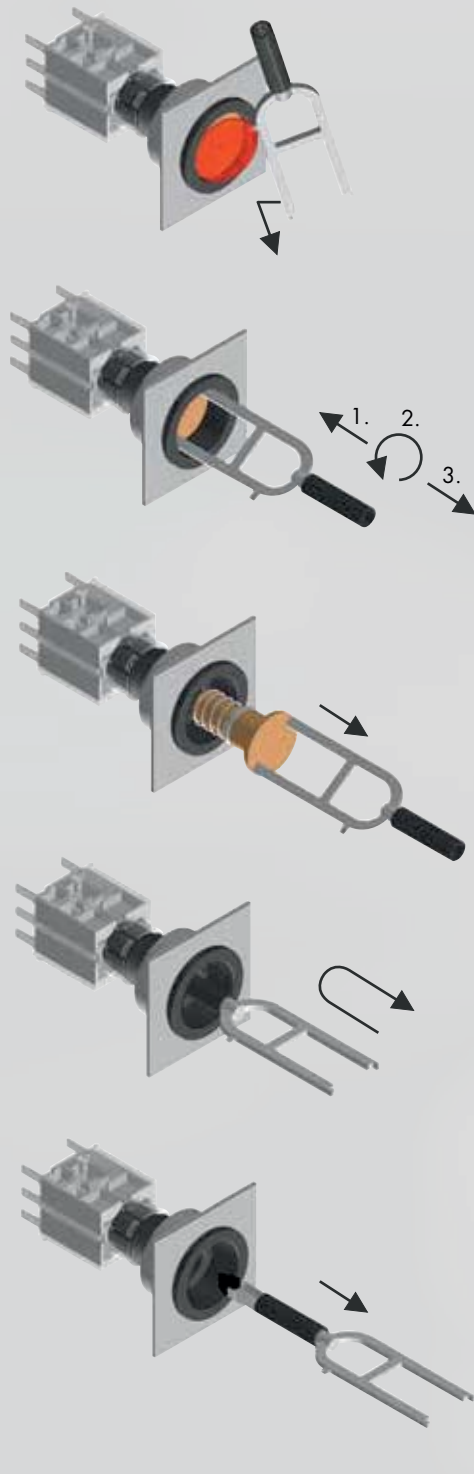

Pushbutton Heads (momentary/push-push)

Lenses and nameplates to be ordered separately

Illustration

Dimensions

Description

Type

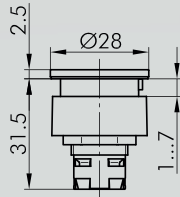

Pushbutton Head

suitable contact blocks



front bezel

charcoal

RXJT



Transparent Lens

colour

- blue
- yellow
- green
- clear
- red
- opalwhite

- T20DBL**
- T20DGB**
- T20DGN**
- T20DKL**
- T20DRT**
- T20DWS**



Concave Lens, non-transparent

used in pushbuttons without inscription and illumination

colour

- blue
- yellow
- green
- black
- red
- white

- T20DGBL**
- T20DGGB**
- T20DGGN**
- T20DGSW**
- T20DGRT**
- T20DGWS**



Nameplate

with standard imprint, please specify index number (see nameplates on pages 410)

BSRX...

Nameplate

with special imprint according to customer's specifications

BSRXB



Blank Nameplate

BSRXU



Sealing Cap

made of PVC, down to -5° C up to +60° C

TK28P

**Emergency Stop Buttons
Mushroom Heads**

Illustration

Dimensions

Description

Type

IP67



Sealing Cap

made of silicone rubber, down to -50°C

TK28S



For further emergency stops, please refer to the chapter „Emergency-stop Heads“ starting on page 362

The emergency-stop heads can also be supplied as latching mushroom heads with mushrooms in different colours.

IP65

16mm

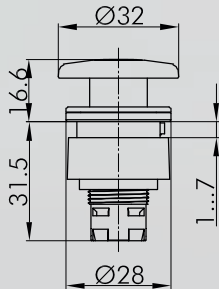

Mushroom Head, momentary

switching position indicator No
anti-lock collar No

suitable contact blocks

A **AZ** **CT** **CTF** **CTP** **Z**

front bezel

charcoal

RXJS

**Knob Set for potentiometers
Selector Heads (momentary/maintained)**

⊥ = Switching position
> = Spring return

Illustration

Dimensions

Description

Type

IP65

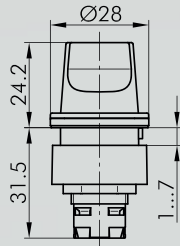

Knob Set for potentiometers

for potentiometers of 6 mm shaft dia. and thread M10 x 0.75.
Delivery without potentiometer.
Shaft length: approx. 50 mm ± 4 mm
knob colour black
front bezel charcoal

RXJR

IP65

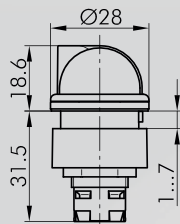

Selector Head, maintained

suitable contact blocks

A **AZ** **CT** **CTF** **CTP** **CZ**

front bezel charcoal

suitable contact blocks

A **AZ**

front bezel charcoal



RXJWA



RXJWB

IP65

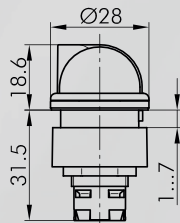

Selector Head, left maintained, right momentary

suitable contact blocks

A **AZ**

front bezel charcoal



RXJWC

IP65

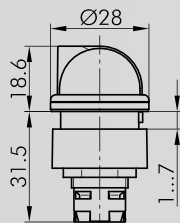

Selector Head, momentary

suitable contact blocks

A **AZ** **CT** **CTF** **CTP** **CZ**

front bezel charcoal

suitable contact blocks

A **AZ**

front bezel charcoal



RXJSTA



RXJSTB

**Selector Heads (momentary/maintained)
Key Actuators (momentary/maintained)**

- I = Switching position
- > = Spring return
- = Key removable position

Illustration

Dimensions

Description

Type

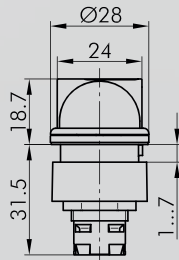

**Illuminated Selector Head, maintained
(two-piece plunger)**

suitable contact blocks

AZ CT Z

front bezel

charcoal

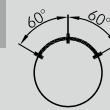

RXJZWBL_KL

IP65

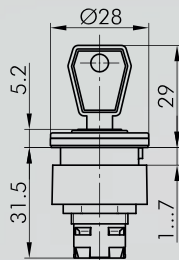

Key Actuator, maintained

including two keys
other lock types on request

suitable contact blocks

A AZ

front bezel

charcoal



RXJSSA12E

suitable contact blocks

A AZ

front bezel

charcoal



RXJSSA13E

suitable contact blocks

A AZ CT CTF CTP Z

front bezel

charcoal



RXJSSA14E

suitable contact blocks

A AZ CT CTF CTP Z

front bezel

charcoal



RXJSSA15E

suitable contact blocks

A AZ CT CTF CTP Z

front bezel

charcoal



RXJSSA17E

suitable contact blocks

A AZ CT CTF CTP Z

front bezel

charcoal



RXJSSA18E

IP65

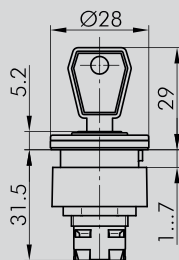

**Key Actuator, maintained
(two-piece plunger)**

including two keys
other lock types on request

suitable contact blocks

AZ CT Z

front bezel

charcoal



RXJZSSA12E

suitable contact blocks

AZ CT Z

front bezel

charcoal



RXJZSSA13E

**Key Actuators (momentary/maintained)
Buzzers**

Illustration

Dimensions

Description

Type

IP65

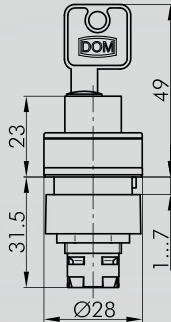

Lockable Pushbutton Head

including two keys

Type N:

Depresses with or without key. Lock latches in depressed position and resets with key turned clockwise. Key removable in both positions.

Type 1:

Depresses only with key turned clockwise. Turn key into vertical position, the lock latches. Reset by turning key clockwise. Key removable in both vertical positions.

Type 2:

Depresses only with key in the right position (= basic position). Turn key into vertical position, the lock latches. Key only removable in the latching position. Reset by turning key clockwise.

Type 3:

Depresses only with key turned clockwise. The lock does NOT latch in depressed position (key neither turnable nor removable in depressed position; MOMENTARY). Key only removable in the off-position.

suitable contact blocks



front bezel

charcoal

RXJSCHA...



Spare Keys

standard spare key, specify key number for special locks

ES3A36



Spare Key (standard)

standard spare key, specify key number for special locks

ESE845

IP65

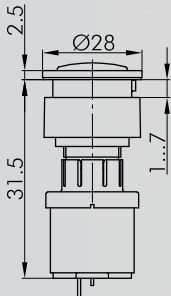

Buzzer

operating voltage: 12 ... 24V AC/DC
 operating current: max. 30mA
 signal frequency: 3.5 +/- 0.5 Hz
 volume: max. 87 db (10cm, 24V)
 max. 85 db (10cm, 12V)
 operating temperature: -20°C ... 60°C
 front bezel charcoal

**RXJNSG+
SG-24V**

Buzzers

Illustration

Dimensions

Description

Type

IP65

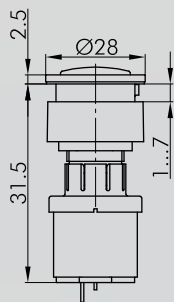

Interval Buzzer

operating voltage: 12 ... 24V AC/DC
 operating current: max. 30mA
 signal frequency: 3.5 +/- 0.5 Hz
 volume: max. 87 db (10cm, 24V)
 max. 85 db (10cm, 12V)
 interval: 1 s
 operating temperature: -20°C ... 60°C
 front bezel: charcoal

**RXJNSG+
SGI-24V**

IP65

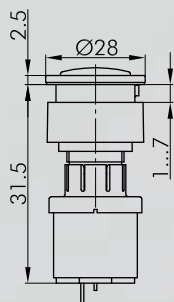

Illuminated Buzzer

Operating voltage: 12 ... 24V AC/DC
 Operating current: approx. 30mA
 Signal frequency: 3.5 +/- 0.5 kHz
 Volume: max. 87 db (10cm, 24V)
 max. 85 db (10cm, 12V)
 Operating temperature: -20°C ... 60°C
 front bezel: charcoal

**RXJNSGL+
SGLR-24V**

IP65

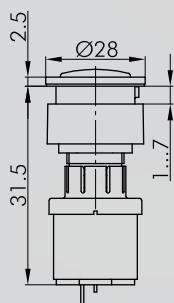

Illuminated Interval Buzzer

Operating voltage: 12 ... 24V AC/DC
 Operating current: approx. 30mA
 Signal frequency: 3.5 +/- 0.5 kHz
 Volume: max. 87 db (10cm, 24V)
 max. 85 db (10cm, 12V)
 Interval: 1s
 Operating temperature: -20°C ... 60°C
 front bezel: charcoal

**RXJNSGL+
SGILR-24V**



Faston Clamp 2.8 x 0.8 mm with snap-in pin

FH2,8

Cross section 0.75 - 1.50 mm², brass, with pin to snapfit into the socket XA, XAL and the insulating case IH2.8



Insulating Case

IH2,8

for Faston clamp FH2,8, slip on from the front

Accessories for Contact blocks

Illustration

Dimensions

Description

Type



Double Faston

for the connection of 2 Faston clamps FH2.8

FD2,8

- Accessories
- Control Units
- Blue Technology
- Faston
- Faston Switches
- Faston Connectors
- Faston Blocks

Pilot Light Heads/Pilot Lights

Lenses and nameplates to be ordered separately

Illustration

Dimensions

Description

Type

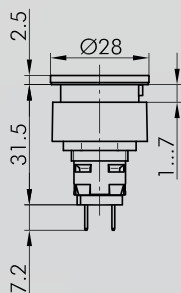

Pilot Light with Faston terminals
2.8x0.8 mm

T5.5K socket

front bezel charcoal

RXJL5

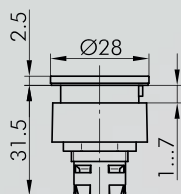

Pilot Light Head

suitable lampholders



front bezel charcoal

RXJN



Convex Lens

| | | |
|--------|--------|---------------|
| colour | blue | KF20BL |
| | yellow | KF20GB |
| | green | KF20GN |
| | clear | KF20KL |
| | red | KF20RT |
| | white | KF20WS |



Hemispherical Lens

| | | |
|--------|-----------|---------------|
| colour | blue | KH20BL |
| | yellow | KH20GB |
| | green | KH20GN |
| | clear | KH20KL |
| | red | KH20RT |
| | opalwhite | KH20WS |



Nameplate







with standard imprint, please specify index number (see nameplates on pages 410)

BSRX...

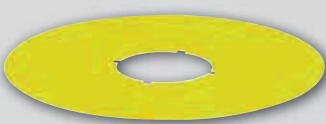
Accessories for Actuators

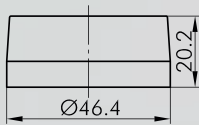
| Illustration | Dimensions | Description | Type |
|--------------|------------|---|-----------------|
| | | Nameplate with special imprint according to customer's specifications | BSRXB |
| | | Blank Nameplate | BSRXU |
| | | Hexagonal Mounting Tool with torque limitation, for the series OKTRON, OKTRON-JUWEL, OKTRON-R, RONTRON-R-JUWEL, RONTRON-R-Exclusive, RONTRON-Q- JUWEL, RONTRON-Q-Exclusive, QUARTRON(-L), QUARTRON- JUWEL(-L), RX, RX-JUWEL | S16 |
| | | Mounting Tool Adapter with 1/4" connections for mounting tools S16 and S22 | SRA |
| | | External Nameplate Holder for outside marking of the actuators of the RX-JUWEL series, accepts self-adhesive nameplates colour charcoal | RXJABT |
| | | Self-adhesive Nameplate - laser-printed Inscription according to customer's specification Dimensions: 22 x 11 mm | BZ16G |
| | | Self-adhesive Nameplate - blank Dimensions: 22 x 11 mm | BZ16U |
| | | Self-adhesive Nameplate with standard inscription, please specify index no. (see nameplates) Dimensions: 22 x 11 mm | BZ16B... |

Accessories for Actuators

| Illustration | Dimensions | Description | Type |
|---|---|--|--------------------------|
|  | | Yellow Nameplate self-adhesive PVC foil printing on request outer dia. 75 mm for mounting dia. 22 mm colour yellow | NAS_22 |
|  | | Yellow Nameplate with quadrilingual imprint self-adhesive PVC foil outer dia. 75 mm for mounting dia. 22 mm colour yellow | NAS_22_548 |
|  |  | Protective Shroud for actuators of 22 mm mounting dia. colour yellow charcoal | RXJSK RXJSKDG |
|  | | Lamp Remover | LZ-MG |
|  | | Universal Lens Remover | USK |
|  | | Service Tool for the RX-JUWEL series | LZ6 |
|  | | Round Dummy to close unused mounting apertures colour charcoal | BVRXJ |

IP65

Power
Control Units
Bus Technology
Switches
Terminal Switches
Terminal Blocks