



Panel cut-out: $\varnothing 16 \text{ mm}$

Travel: $3 / 6 \text{ mm}$



mini Actuators

Index
About Us
Control Units
Actuators
Bus Technology
Endeffector
Limit Switches
Travel Switches
Terminal Blocks



	LMN	LMT	NXD	QMD	QMN	QMT	RMN	RMT
AF		●				●		●
AF2		●				●		●
AFL		●				●		●
AFL2		●				●		●
AL5	●				●		●	
AL5-220	●				●		●	
AT		●				●		●
AT2		●				●		●
ATI		●				●		●
ATL		●				●		●
ATL2		●				●		●
ATO		●				●		●
AZ2		●				●		●
AZOO		○				○		○
AZOW1		○				○		○
CL	●				●		●	
CLP_485	●				●		●	
CT		○				○		○
CT2		○				○		○
CTF		○	●	●		○		○
CTL		○				○		○
CTL2		○				○		○
CTLF		○	●	●		○		○
CTLP_485		○	●	●		○		○
CTP_485		○	●	●		○		○
CZLP	●				●		●	
CZTLP		○				○		○
CZTLP2		○				○		○
CZTP		○				○		○
CZTP2		○				○		○
PTFOI			●	●				○
PTFOO			●	●				○
PTPOI			●	●				○
PTPOO			●	●				○

- possible combination
- optimal combination

Mini Actuators

Ø 16 mm

Pushbutton Heads (momentary/push-push)

Lenses and nameplates to be ordered separately

Illustration

Dimensions

Description

Type

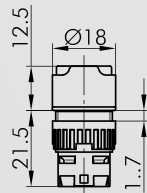

Pushbutton Head

Mounting grid:
CLP_485 18 x 18 mm
A.../B.../C... 25 x 25 mm
front bezel black

RMT



Transparent Lens

available in blue-BL, yellow-GB, green-GN, clear-KL, red-RT, opalwhite-VS, add code letter to type number, e.g. T16RRT

T16R...



Nameplate

with standard imprint, please specify index number (see nameplates)

BS16R...



Blank Nameplate

BS16RU



Nameplate

with special imprint according to customer's specifications

BS16RB

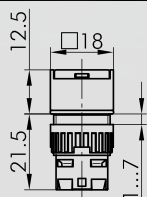

Pilot Light Head

Mounting grid:
CTP_485 18 x 18 mm
A.../B.../C... 25 x 25 mm
front bezel black

QMT

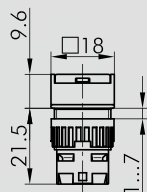

Short-stroke Pushbutton Head

Mounting grid:
CTP_485 18 x 18 mm
A.../B.../C... 25 x 25 mm
front bezel black

QMD

Pushbutton Heads (momentary/push-push)

Lenses and nameplates to be ordered separately

Illustration	Dimensions	Description	Type
		Transparent Lens available in blue-BL, yellow-GB, green-GN, clear-KL, red-RT, opalwhite-WS, add code letter to type number, e.g. T16QRT	T16Q...
		Nameplate with standard imprint, please specify index number (see nameplates)	BS16Q...
		Blank Nameplate	BS16QU
		Nameplate with special imprint according to customer's specifications	BS16QB
     		Pushbutton Head Mounting grid CTP_485 24 x 18 mm A.../B.../C... 25 x 25 mm front bezel black	LMT
		Transparent Lens available in blue-BL, yellow-GB, green-GN, clear-KL, red-RT, opalwhite-WS, add code letter to type number, e.g. T16LRT	T16L...
		Nameplate with standard imprint, please specify index number (see nameplates)	BS16L...
		Blank Nameplate	BS16LU

- Index
- Mini Actuators
- Central Units
- Bus Technology
- Follow-ups
- Limit Switches
- Pedal Switches
- Terminal Blocks

Mini Actuators

Ø 16 mm

Pushbutton Heads (momentary/push-push)

Lenses and nameplates to be ordered separately

Illustration

Dimensions

Description

Type

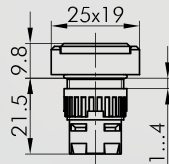

Pushbutton Head

Mounting grid:
CTP_485 25 x 19 mm
A.../B.../C... 25 x 25 mm
front bezel black

NXD

Transparent Lens

available in blue-BL, yellow-GB, green-GN, clear-KL,
red-RT, opalwhite-WS,
add code letter to type number, e.g. T19FRT

T19F...

Nameplate

with standard imprint, please specify index number
(see nameplates)

BSNX...

Nameplate

with special imprint according to customer's specifications

BSNXB



Blank Nameplate

BSNXU

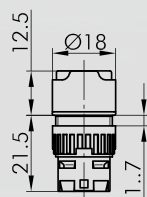

Pilot Light Head

Mounting grid:
CLP_485 18 x 18 mm
A.../B.../C... 25 x 25 mm
front bezel black

RMN



Transparent Lens

available in blue-BL, yellow-GB, green-GN, clear-KL,
red-RT, opalwhite-WS,
add code letter to type number, e.g. T16RRT

T16R...



Nameplate

with standard imprint, please specify index number
(see nameplates)

BS16R...

Pilot Light Heads/Pilot Lights

Lenses and nameplates to be ordered separately

Illustration	Dimensions	Description	Type
		Nameplate with special imprint according to customer's specifications	BS16RB
		Blank Nameplate	BS16RU
 		Pilot Light Head Mounting grid CLP_485 18 x 18 mm A.../B.../C... 25 x 25 mm front bezel black	QMN
		Transparent Lens available in blue-BL, yellow-GB, green-GN, clear-KL, red-RT, opalwhite-WS, add code letter to type number, e.g. T16QRT	T16Q...
		Nameplate with standard imprint, please specify index number (see nameplates)	BS16Q...
		Nameplate with special imprint according to customer's specifications	BS16QB
		Blank Nameplate	BS16QU
 		Pilot Light Head Mounting grid CLP_485 24 x 18 mm A.../B.../C... 25 x 25 mm front bezel black	LMN

Index
 Mounting
 Central Units
 Actuators
 Bus Technology
 Followers
 Limit Switches
 Pedal Switches
 Terminal Blocks

Accessories for Actuators

Illustration	Dimensions	Description	Type
--------------	------------	-------------	------



Transparent Lens

available in blue-BL, yellow-GB, green-GN, clear-KL, red-RT, opalwhite-WS, add code letter to type number, e.g. T16LRT

T16L...



Nameplate

with standard imprint, please specify index number (see nameplates)

BS16L...





Blank Nameplate

BS16LU

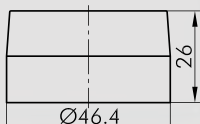
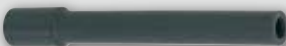

Accessories for Actuators

Illustration	Dimensions	Description	Type
		Mounting Tool for the types NXD, QMD, QMT, LMT, RMT and the S16 series	S16S
		Yellow Nameplate self-adhesive PVC foil printing on request outer dia. 60 mm for mounting dia. 16 mm colour yellow	NAS_16
		Yellow Nameplate with quadrilingual imprint self-adhesive PVC foil outer dia. 60 mm for mounting dia. 16 mm colour yellow	NAS_16_548
 		Yellow Protective Shroud for actuators of 16 mm mounting dia. colour yellow	QXSK
		Lamp Remover	LZ-MG
		Universal Lens Remover	USK

- Index
- Mounting
- Control Units
- Actuators
- Bus Technology
- Indicators
- Limit Switches
- Foot Switches
- Terminal Blocks