

DUX-Standard

Wherever the design of a control panel requires high robustness, a long life and secure function, the control units of the DUX-Standard series are the right ones. Their actuators are often used to complete existing panels, for replacement purposes and especially in cases searching for budget-priced solutions.

Protection Type IP65

The control units of the DUX-Standard series are hand-operated electrical components for mounting dia. 22.3 mm. They serve to switch auxiliary circuits and are used in processing and manufacturing machines, in the

shipbuilding industry, in the construction of rail vehicles, in cranes and elevators and in many other electrotechnical branches. The actuators are available in impact-proof plastics with black or charcoal front bezel, alternatively with chromed metallic front bezel.

Offers a great number of individual marking possibilities.

Approvals

(detailed information on request)

Germany



Canada



Netherlands



ENEC



CE



GL



UL



Mounting Dimensions:

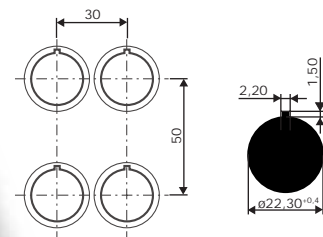

A Company of



DUX Schaltgeräte GmbH

Schönbachstr. 93 Postfach 271113

D-04299 Leipzig D-04291 Leipzig

Phone +49 341 86872-0

Fax +49 341 86872-33

<http://www.dux.de>

E-Mail: info@dux.de



DUX-Standard

The **DUX-Standard** series offer all important types of actuators.



Mounting depth dimensions



*) illuminated push-button 52 mm

The DUX-Standard series fit the following contact blocks:

Standard contact blocks with screw connections for front-panel mounting, type series ET...



Technical Data:

finger protected connections acc.to VDE 0106 T100 and VBG 4.
VDE 0660 sect. 200/EN60947-5-1 IEC 947-5-1
AC 15 A600; lth: 10A
250 V AC/10(6)A; 400 V AC/6A

Modular contact system with screwless CAGE-CLAMP connecting system, type series DT...



Technical Data:

finger protected connections acc.to VDE 0106 T100 and VBG 4.
VDE 0630 sect. 1/EN 61058-1 IEC 1058-1
Category D
400 V AC/10(5)A

Modular contact system with screw connections for front-panel and base plate mounting, type series MT...



Technical Data:

finger protected connections acc.to VDE 0106 T100 and VBG 4.
VDE 0660 sect. 200/EN60947-5-1 IEC 947-5-1
AC 15 A600; lth: 16A
440 V AC/6(4)A; 250 V AC10(6)A



DUX Schaltgeräte GmbH
Schönbachstr. 93 Postfach 271113
D-04299 Leipzig D-04291 Leipzig

Phone +49 3 41 8 68 72-0
Fax +49 3 41 8 68 72-33
<http://www.dux.de>
E-Mail: info@dux.de