

QUARTEX-R / RONDEX / KOMBITAST-R

QUARTEX-R, RONDEX, KOMBITAST-R

a thought-out design and an optimum exploitation of panel surface are significant signs for communication and operation. Individual application possibilities, high roughness and max. assembly facilities are features of these series.

Control units of the QUARTEX-R, RONDEX and KOMBITAST-R series are hand-operated electrical components for mounting diameters of 22.3 mm and 30.5 mm.

Offers a great number of marking possibilities as many interchangeable nameplates are available.

**Protection type IP65
Protection class II**

International Design Awards:



Approvals

(detailed information on request)

Germany



Canada



Netherlands



ENEC



UL



Norway



Finland



Mounting dimensions:

QUARTEX-R

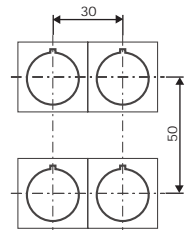
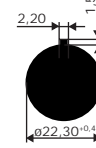

RONDEX

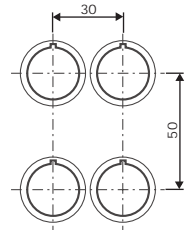
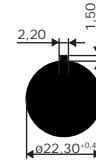

KOMBITAST-R

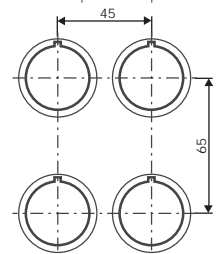

Georg Schlegel GmbH & Co.
Elektrotechnische Fabrik
D-88525 Dürmentingen
Phone +49 7371/502-0
Fax +49 7371/502 49
<http://www.schlegel.biz>
E-Mail: info@schlegel.biz

SCHLEGEL®
ELEKTROKONTAKT

QUARTEX-R / RONDEX / KOMBITAST-R

The **QUARTEX-R**, **RONDEX** and **KOMBITAST-R** series offer all important types of actuators

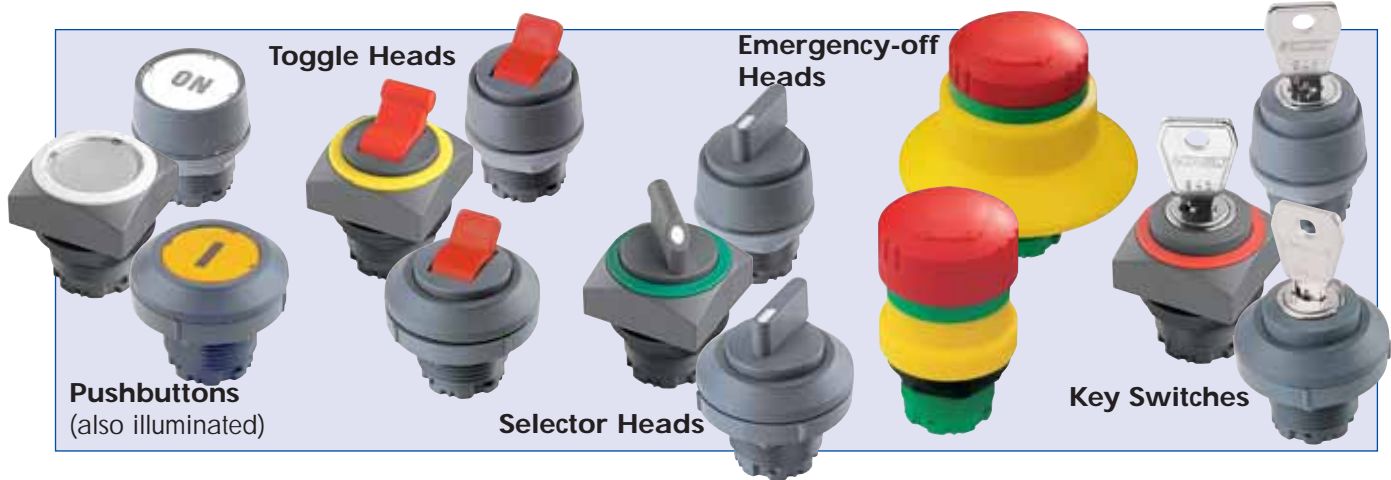

Mounting depth dimensions



The QUARTEX-R, RONDEX and KOMBITAST-R series fit the following contact blocks

Standard contact blocks with screw connections for front-panel mounting, type series ET...



Technical Data:

finger protected connections acc. to VDE 0106 T100 and VBG 4.
VDE 0660 sect.200/EN60947-5-1
IEC 947-5-1
AC 15 A600; lth: 10A
250 Vac/10(6)A; 400 Vac/6A

Modular contact system with screwless CAGE-CLAMP connecting system, type series DT...



Technical Data:

Safe-to-touch connections acc. to VDE 0106 T100 and VBG 4.
VDE 0630 sect. 1/EN 61058-1
IEC 1058-1
Category D
400 Vac/10(5)A

Modular contact system with screw connections for front-panel and base plate mounting, type series MT...



Technical Data:

Safe-to-touch connections acc. to VDE 0106 T100 and VBG 4.
VDE 0660 sect. 200/EN60947-5-1
IEC 947-5-1
AC 15 A600; lth: 16A
440 Vac/6(4)A; 250 Vac10(6)A