

Special Steel Control Units

RVA Series

RVA control units for exclusive application in a rough area. Special steel makes these series noble, robust and corrosion-proof. Coloured base rings make individual design possible. The illuminated pushbuttons are equipped with an illuminated circular push-cap area. An excellent contact reply increases the operating comfort. Through flexible contact equipment and simple assembly these series can be used for each application.

RVA control units are hand-operated electrical components for a mounting diameter of 22.3 mm.

The surface of the pushbuttons can be inscribed by laser according to your wishes.

Approvals

(detailed information upon request)

Germany



Canada



Netherlands



ENEC



CE



GL



UL



Mounting dimensions:

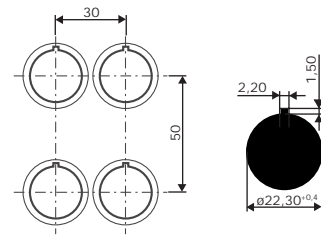

Design
Award
Winner
2000



reddot



Georg Schlegel GmbH & Co.
Elektrotechnische Fabrik
D-88525 Dürmentingen
Phone +49 7371/502-0
Fax +49 7371/502 49
http://www.schlegel.biz
E-Mail: info@schlegel.biz

SCHLEGEL[®]
ELEKTROKONTAKT

Special Steel Control Units

RVA Series

The **RVA** series offer all important types of actuators.



Mounting depth dimensions



*) illuminated pushbuttons 50 mm

The RVA series fit the following contact blocks:

Standard contact blocks with screw connections for front-panel mounting, type ET...



Technical Data:

Safe-to-touch connections acc. to VDE0106 T100 and VBG 4.
VDE0660 sect. 200/EN60947-5-1 IEC 947-5-1
AC 15 A600; Ith: 10A
250Vac/10(6)A; 400Vac/6A

Modular contact system with screwless CAGE-CLAMP connecting system for front-panel and base plate mounting, type DT...



Technical Data:

Safe-to-touch connections acc. to VDE0106 T100 and VBG 4.
VDE 0630 sect. 1/EN 61058-1 IEC 1058-1
Category D
400Vac/10(5)A

Modular contact system with screw connections for front-panel and base plate mounting, type MT...



Technical Data:

Safe-to-touch connections acc. to VDE0106 T100 and VBG 4.
VDE0660 sect. 200/EN60947-5-1 IEC 947-5-1
AC 15 A600; Ith: 16A
440Vac/6(4)A; 250Vac10(6)A